

GENIXGREEN[®]

ES-BOX12F Series

5.12kWh/10.24kWh/14.34kWh/16.08kWh

Suitable for all weather, indoors or outdoors



Available in 3 Colors



Flexible installation
saving time and effort



1C/1C continuous
charge and discharge



10 years
standard warranty



IP65 Protection
Fearless of outdoor installation,
strong environmental adaptability



Max. 64
modules parallel



Battery Equalization
Supports for mixing modules under
different SOC to ensure battery life



All-round Safety
Short-circuit lockout,
surge-resistant, safe, and reliable



Automatic Self-heating
-20°C to 55°C
operating temperature(optional)

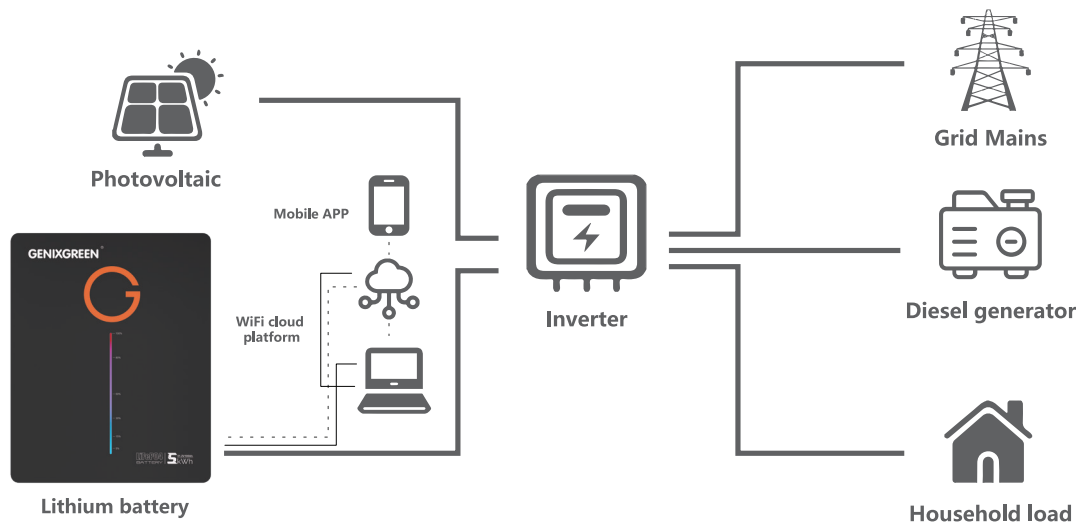

Product Specification

Product Model	ES-BOX12F	ES-BOX12F PLUS	ES-BOX12F MAX	ES-BOX12F MAX+
Nominal Energy	5.12kWh	10.24kWh	14.34kWh	16.08kWh
Nominal Voltage	51.2V			
Nominal Capacity	100Ah	200Ah	280Ah	314Ah
Cell Type	LFP			
Standard Charge Voltage	56.8V			
Max.Charge/Discharge Current	100A	150A	200A	200A
Discharge Cut-Off Voltage	44.8V			
Parallel Function	Parallels: Max.16, Max.33, Max.64 (Optional)			
Communication Interface	RS485,RS232,CAN			
Cycle Life	>8000 Cycles(25°C±2°C, 0.5C, 90%DOD@65%EOL)		≥10000 Cycles (25°C±2°C, 0.35C, 90%DOD@65%EOL)	
Charge Temperature Range	0~55°C			
Discharge Temperature Range	-20~55°C			
Certification	Pack: CEI 0-21/CE/IEC 62619/UL1973 by Intertek/MSDS/UN38.3 Cell: UL1642/IEC 62619/CE/EMC/ROHS/MSDS/UN38.3			
Dimension	480*600*180mm (Excluding Wall-Mounted Brackets)	480*650*245mm (Excluding Wall-Mounted Brackets)	490*840*250mm (Excluding Wheels)	490*840*250mm (Excluding Wheels)
Net Weight	52Kg	98Kg	126Kg	128Kg
Installation Method	Wall-Mounted/Floor Standing			
Warranty	10 years warranty, 15 years design life			
Energy Throughput ^[1]	22MWh	44MWh	62MWh	70MWh
Display	RGB LED Light			
Include	Circuit Breaker			
Optional	Automatic Heating,Fire Extinguishing Module,WiFi Remote Monitoring			
Protection Grade	IP65			

[1] Conditions apply, refer to GENIXGREEN warranty letter.